

PARTS LIST

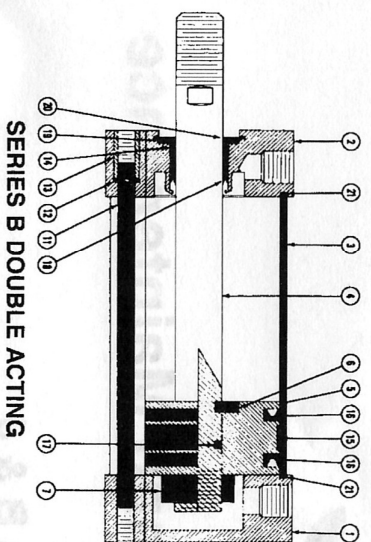

SERIES B DOUBLE ACTING

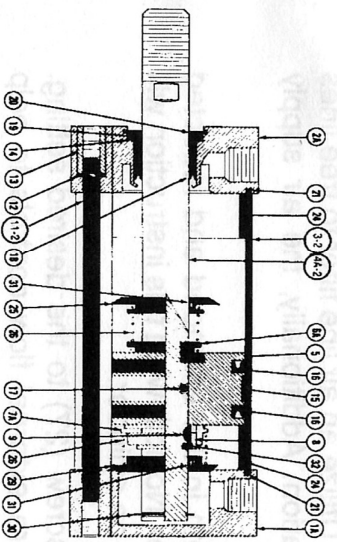

SERIES B DOUBLE CUSHION

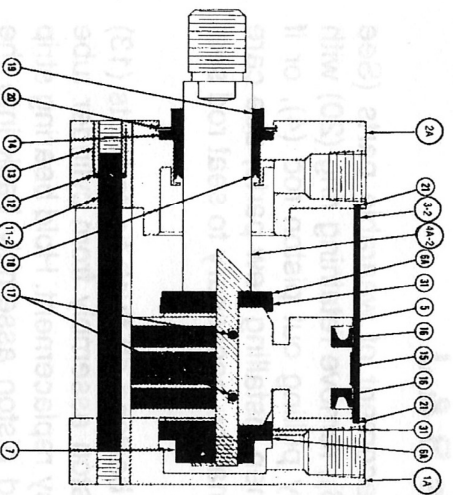

SERIES J DOUBLE CUSHION

P/N	DESCRIPTION	QTY.
1	REAR CAP	1
1A	REAR CAP CUSHIONED (WITH P/N 27 & 18)	1
2	FRONT HEAD	1
2A	FRONT HEAD CUSHIONED (WITH P/N 27 & 28)	1
3	CYLINDER TUBE	1
3-1	CYLINDER TUBE (CUSHION ONE END)	1
3-2	CYLINDER TUBE (DOUBLE CUSHION)	1
4	PISTON ROD	1
4A	PISTON ROD — REAR CUSHION (WITH P/N 7A, 8 & 9)	1
4A-1	PISTON ROD — FRONT CUSHION	1
4A-2	PISTON ROD — DOUBLE CUSHION (WITH P/N 7A, 8 & 9)	1
4A-B	PISTON ROD — DOUBLE ROD END (WITH P/N 7A, 8 & 9)	1
5	PISTON	1
6	PISTON SUPPORT	1*
6A	PISTON SUPPORT CUSHIONED	1*
7	PISTON NUT	1
7A	PISTON NUT (REAR CUSHION & DOUBLE ROD END)	1*
8-9	SPLIT SCREW & KEY	1*
10	PISTON ROD JAM NUT	1*
11	TIE ROD	4
11-1	TIE ROD (CUSHION ONE END)	4
11-2	TIE ROD (DOUBLE CUSHION)	4
12	TIE ROD LOCKWASHER	4
13	TIE ROD NUT	4
14	ROD BUSHING	1
15	PISTON BEARING STRIP	1
16	PISTON SEAL	2
17	PISTON ROD "O" RING	1*
18	ROD SEAL (STANDARD)	1
18PP	ROD SEAL (HYDRAULIC)	1
19	ROD WIPER	1
20	BUSHING RETAINING RING	1
21	TUBE SEAL GASKET OR ("O" RING J SERIES)	2
24	CUSHION INSERT	1*†
25	FRONT CUSHION	1*
26	CUSHION SPRING	1*†
27	CUSHION SCREW	1†
28	CUSHION SCREW "O" RING	1†
29	REAR CUSHION	1*
30	REAR CUSHION RETAINING RING	1*
31	CUSHION SEAL	1†
32	SPLIT SCREW SUPPORT	1*

NOTE: * Difference in quantities between series

† Per cushion

REPAIR KITS

Repair kits containing all wearable replacement parts are available.

Please specify cylinder model, single or double ended, type of cushion, air or hydraulic operated and any options which affect repair kit.

(B&J) STANDARD REPAIR KIT CONTAINS: P/N 14, 15, 16, 17, 18, 19, 20 & 21.

(B) REAR CUSHION REPAIR KIT CONTAINS: Standard repair kit plus P/N 26, 28, 30 & 31.

(B) FRONT CUSHION REPAIR KIT CONTAINS: Standard repair kit plus P/N 26, 28 & 31.

(J) CUSHION REPAIR KIT CONTAINS: Standard repair kit plus P/N 28 & 31.

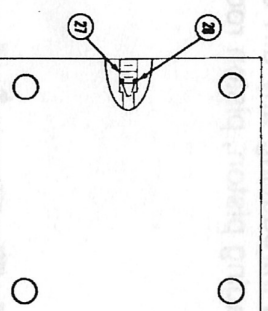

SERIES B & J CUSHION ADJUSTMENT